

Concrete Pavers with Adjustable Pedestals

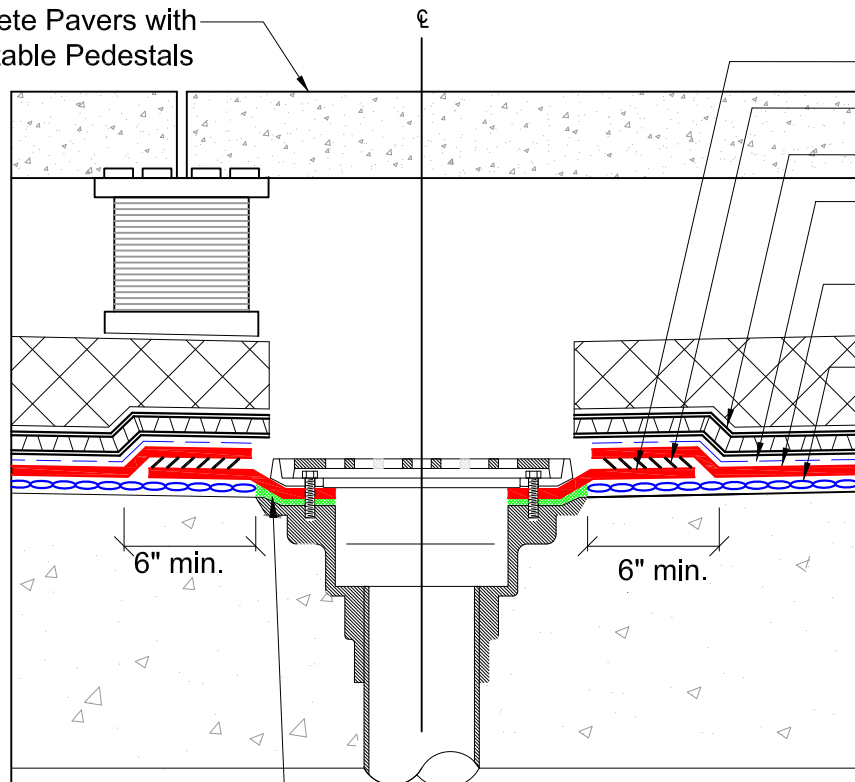

- PVC Target Flashing Strip @ Drain Body
- Hot Air Weld
- Gard-Drain 700/or 990
- HDPE Protection Roll or Hydro-Ultra Mat 12 oz (Spot Weld Seams of HDPE)
- Hydro-Prufe 80 mil PVC Membrane (Loose Laid)
- Hydro-Ultra Mat 12oz
- 60 psi XPS Insulation

6" min.

6" min.

Clean Drain Ring and apply a heavy bedding of SAF-30 at Drain as shown and immediately embed Hydro-Prufe Flashing Strip into wet SAF-30. Install Clamping Ring and Bolt securely.  
(Apply SAF-30 to Drain Body a minimum of ¼" thick)



DETAIL NAME:  
**DRAIN @ PAVERS w/ PEDESTALS**

JOB NAME:

Scale:	Date:	Drawing #:
NTS	12-01-14	HP-DR-003