

- Termination Bar
- HP 9112 MMA Primer
- Gard-Drain 700/or 990
- HDPE Protection Roll or
Hydro-Ultra Mat 12 oz
(Spot Weld Seams of HDPE)
- Hydro-Prufe 80 mil PVC
Membrane (Loose Laid)
- Hydro-Ultra Mat 12oz
- HP Liquid Flashing 9800
& Fabric Reinforcement
- Aggregates Embedment in HP-9800
Liquid Flashing
- Gard-Drain 700 or 990
- Hydro-Tuff PB 25
- Hydro-Tuff HFA Membrane
- Hydro-Primer

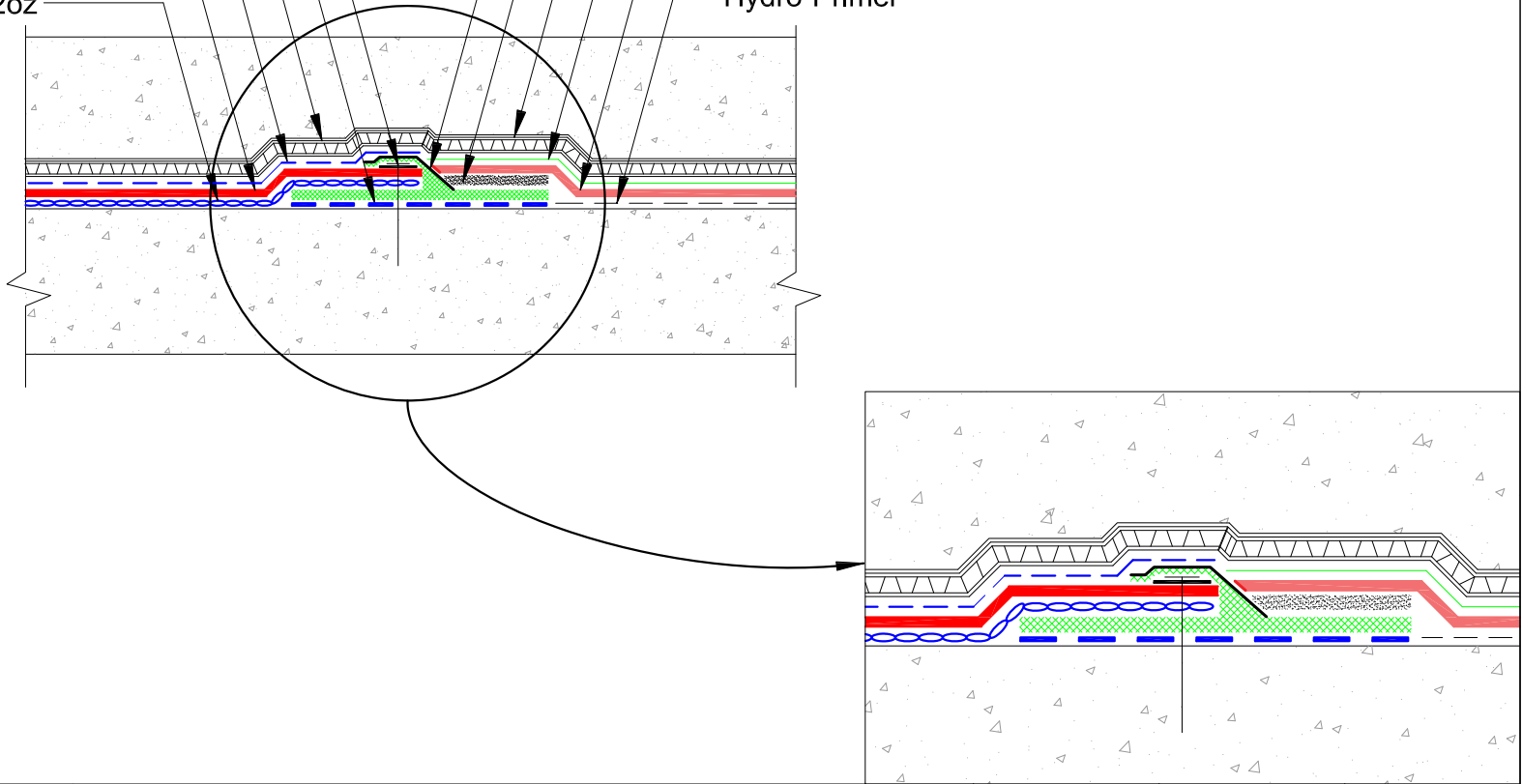

DETAIL NAME:

TIE-IN (HYDRO-PRUFE & HYDRO-TUFF)

JOB NAME:

Scale:

NTS

Date:

10-27-14

Drawing #:

HP-SD-003